

M-2000iA/1200



Max. load capacity
at wrist: 1200 kg



Max. reach:
3734 mm

FANUC

Robot			Max. load capacity at wrist (kg)	Reach (mm)	Controlled axes	Repeatability (mm)	Mechanical weight (kg)	Motion range (°)						Maximum speed (°/s)						Moments (N-m)/Inertia (kg-m ²)			Average Power consumption (kW)	Protection	
Series	Version	Type						J1	J2	J3	J4	J5	J6	J1	J2	J3	J4	J5	J6	J4 Moment/ Inertia	J5 Moment/ Inertia	J6 Moment/ Inertia		Body standard/optional	Wrist & J3 arm standard/optional
M-2000	iA	1200	1200 (1350)*	3734	6	±0.18**	8600	330	160	165	720	240	720	45	30	30	50	50	70	14700/ 2989	14700/ 2989	4900/ 2195	8	IP54/ IP56	IP67

● standard ○ on request - not available () with hardware and/or software option ** based on ISO9283 * option

M-2000iA/1200

Standard model

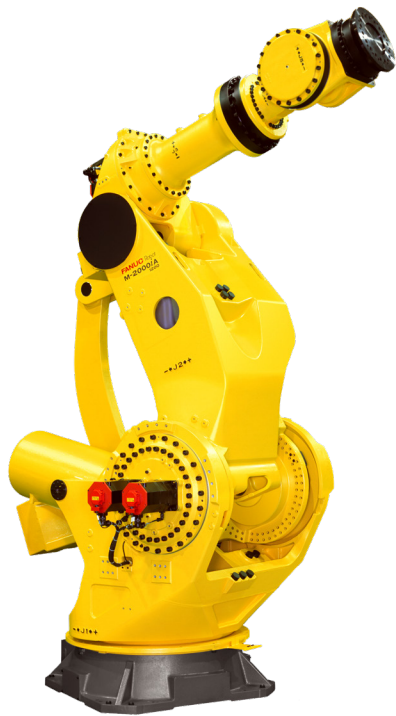

Rear side
Interference area

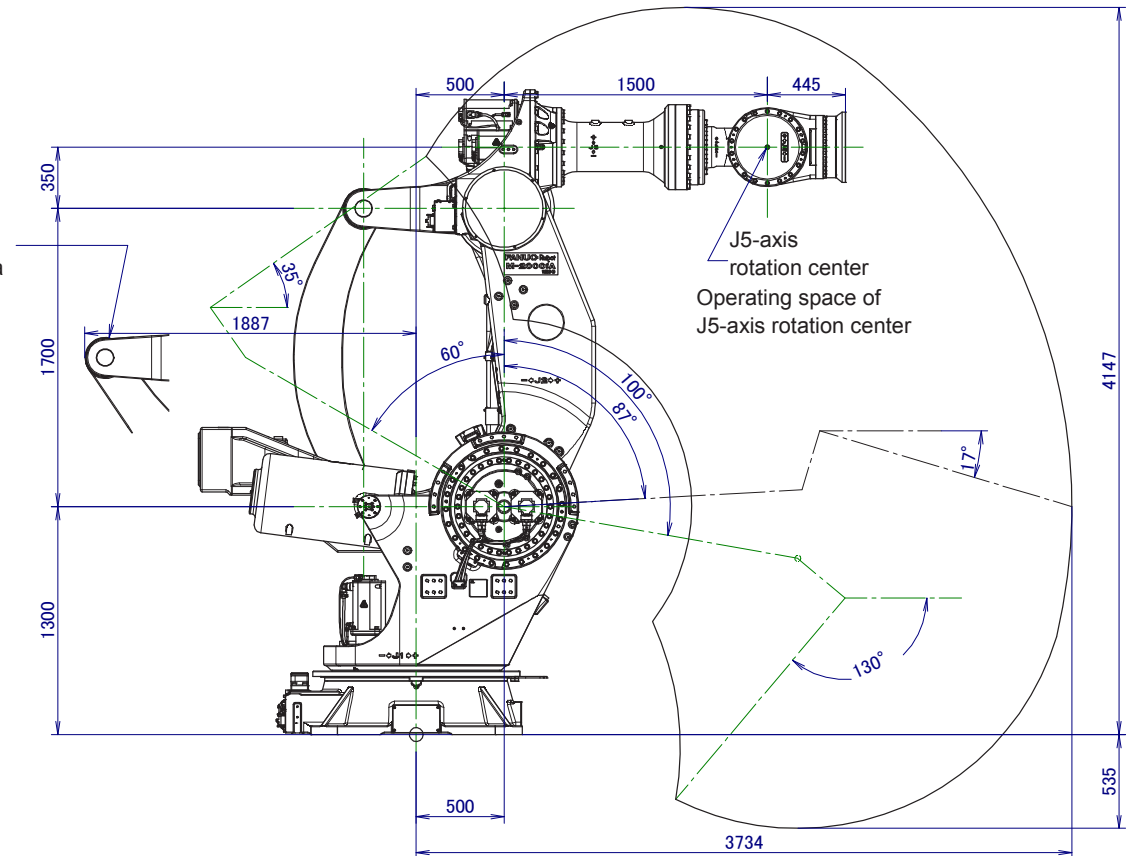

M-2000iA/1200